

Vespa

Member of E. Bon Group



Kitchen
Wardrobe
Collection

Vespa. A symbol of uniqueness and functionality.

At Vespa, kitchen systems are designed and built to suit the needs of each customer, taking you to the room of culinary pleasure and private time with family. Wardrobes and walk-in closets are arranged to keep garments and accessories tidily and easily accessible.

The interior space is thoughtfully considered. Storage potential is executed. Items are well-organised. Equipped with durable, imported hardware.

Vespa，款式獨特與實用的象徵。

Vespa 廚櫃設計以人為本。個性化的設計配合客戶需要，引領你探索煮食的樂趣，與家人共享下廚的珍貴時光。衣櫃及步入式衣櫃間格一目了然，讓你輕易拿取所需物品。

廚櫃及衣櫃與室內空間配合得宜，儲物空間得到實現。物件擺放得井井有條。進口五金配件堅固耐用。



KITCHEN

VP-1	VP-2	VP-3
8 - 15	16 - 25	26 - 33

VP-4	VP-5	VP-6
34 - 39	40 - 43	44 - 47

WARDROBE

WP-1	WP-2	WP-3
48 - 53	54 - 55	56 - 61

ABOUT US

Experienced.

Our team is comprised of passionate sales persons, kitchen designers and technical specialists who have worked in the industry for more than 20 years.

Detail-minded.

We exchange ideas with customers and propose innovative solutions based on our technical know-how.

Strive for the excellence.

We are committed to delivering the best design, product quality, installation and after-sale support at customers' satisfaction and beyond their expectations.

We are a member of E. Bon Holdings Limited (HKEx Stock Code: 00599), a company listed on The Stock Exchange of Hong Kong Limited.

關於我們

富有經驗

我們的銷售、設計、技術支援團隊從事廚櫃衣櫃行業逾二十年，充滿熱誠，對產品設計及功能有相當的認識。

悉心設計、注意細節

我們深入了解客戶需要，結合自身的專業知識，向客戶提出創新的解決方案。

追求卓越

我們致力使客戶稱心滿意，提供最佳的產品設計、品質、安裝及售後支援，並精益求精，超乎客戶預期。

我們的母公司為怡邦行控股有限公司(股份代號:00599)，一間於香港聯合交易所有限公司上市之公司。



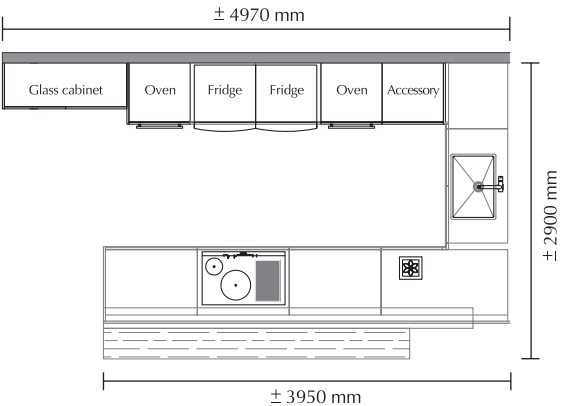



Kitchen featured in low-tone colour scheme. Door panels in dark brown veneer, grey FENIX NTM (nanotechnology matt materials) coating, and grey glass with carbon-grey frame. The hidden profile pull-out handles of drawers give a sleek look without compromising the ease of use. A good pair with lighting to elegantly speak itself.

以深色為主調，採用深啡色木紋灰色納米門板，碳灰拉絲鋁門框及灰玻璃。收納櫃採用隱藏式拉門，在美觀和實用之間取得平衡，配合燈光效果營造出現代高尚感。







VP-2

Vespa

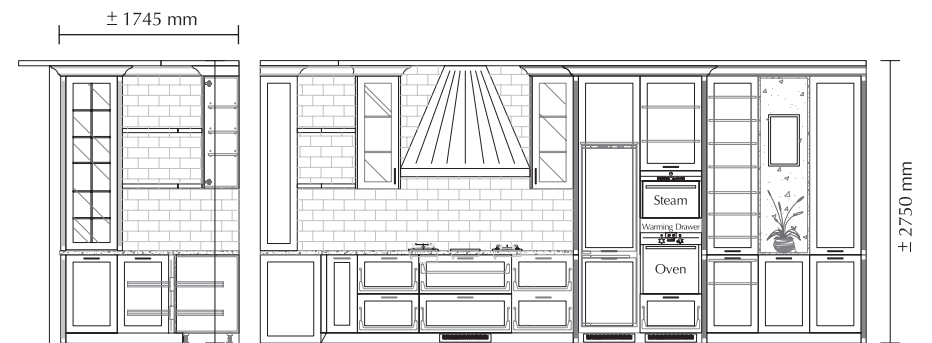
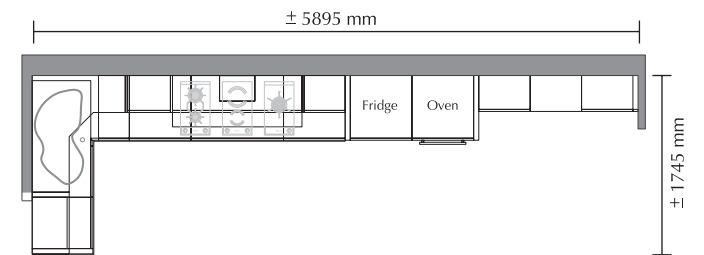





Modern classic is timeless. The grooves on raised/recessed door panel draw the outline of the storage system, while the classy handle poses a sophisticated touch. The kitchen is nonetheless modern - storage interior is equipped with durable hardware, storage accessories and lighting system to suit the usage preference in modern life.

設計採用現代古典風格，以各種花線配合典雅抽手、內置耐用五金及收納配件及照明系統，既保持經典外型亦不失實用性。







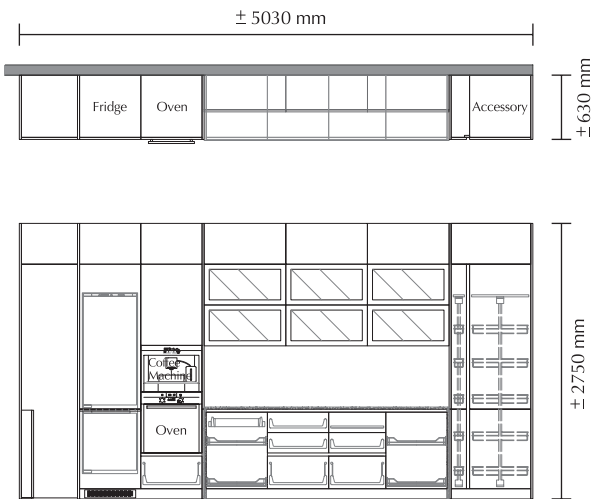



Built by the smooth white door panels in Acrylic coating. Easily flip up the wall cabinet door by motor. The quartz countertop in marble-veins pattern adds warmth to the design. Clean, simple and care-free.

純白亞克力板，白色玻璃電動吊櫃門配上大理石紋石英石枱面，特別適合喜歡簡約主義一族。





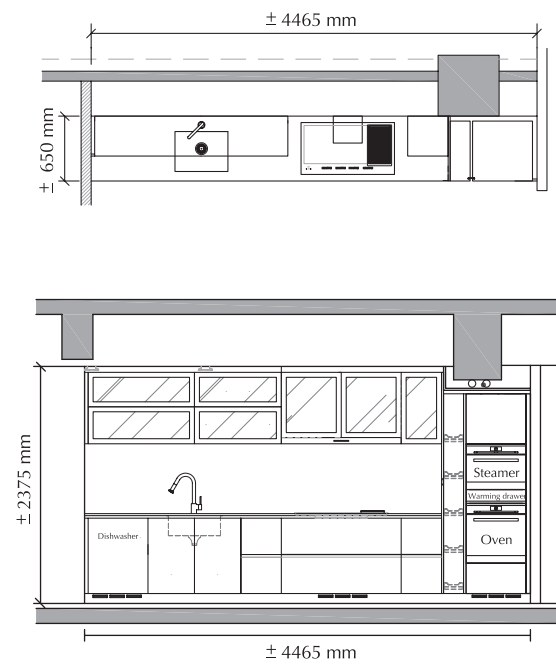



The glass front panels create a clean and spacious feeling. The bar table, topped by a piece of quartz in marble-veins pattern, is the ideal place to spend at home where you will have lots of fun in cooking and dining.

吊櫃配置透明度較高的水晶玻璃門增加空間感。中間放置大理石紋石英石吧枱，讓備餐和用餐一體化之餘，亦可享受當中的樂趣。





VP-5

Vespa

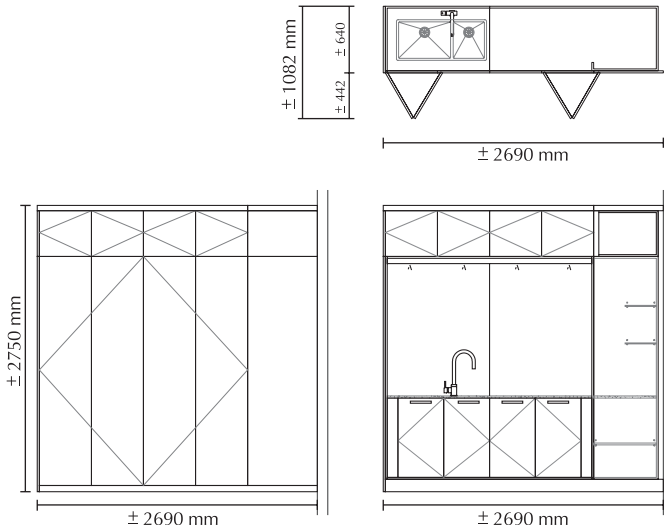

Essential elements are the key in this ultra-simplified design. A slim structure whose lines visually extends to the entire interior space.

採用極簡佈局，只保留必要元素，廚櫃纖薄輕盈，線條與整體室內空間呼應。





VP-6

Vespa

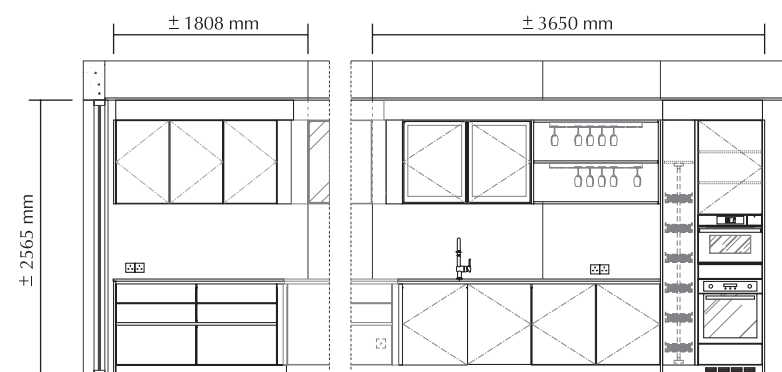
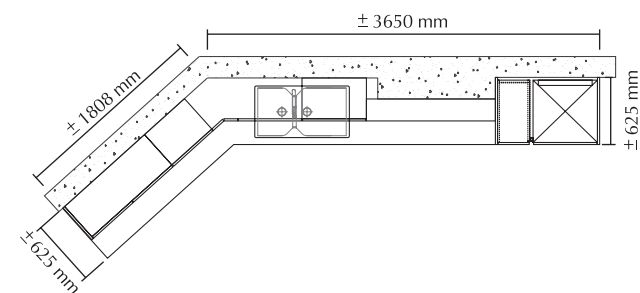

Kitchen cabinets feature individual design, different materials and thoughtful features. The cabinet is equipped with a Vespa faucet and stainless steel zinc plate, the zinc plate is made of 304 stainless steel, easy to clean and easy to care for.

廚櫃具有個性化設計、豐富的材料選擇和貼心的功能。櫥櫃設置自家品牌龍頭及不鏽鋼鋅盤，鋅盤採用304不鏽鋼，易於清潔，方便打理。



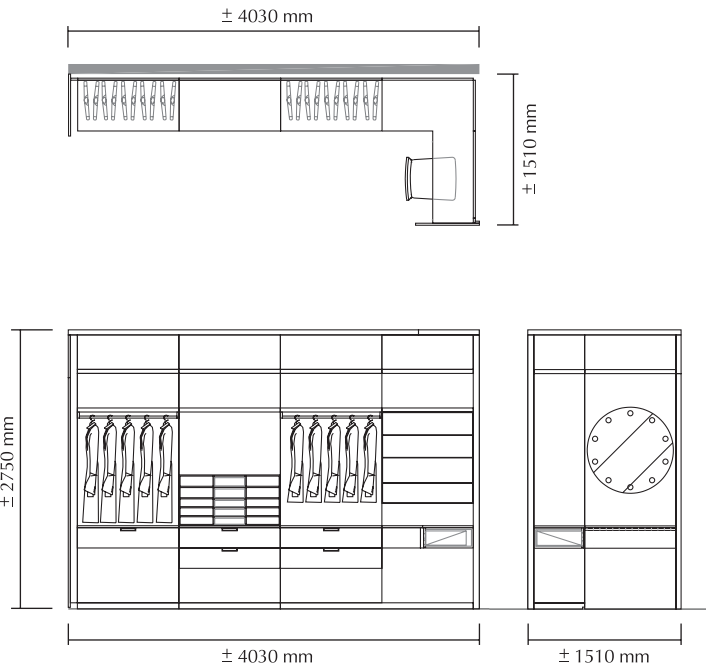





Modular design of wardrobe allows flexibility in meeting the needs of user to a personal level. The open walk-in closet unifies different storage components and optimises the use of space. A complete view of garments is always pleasing.

全模組化靈活衣帽間旨在為空間帶來個性化，照顧不同衣物收納空間。無結構側板設計，使全個衣帽間一覽無遺。

Pocket doors run to the side of wardrobe, saving space and giving an endless design look.

隱藏式櫃門設計，打開門後可將門板收入櫃體內，左邊櫃桶是一個隱藏式梳妝檯，右邊櫃桶是一個電子夾萬，兼顧美觀及盡用櫃內空間。

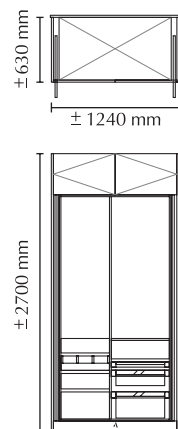

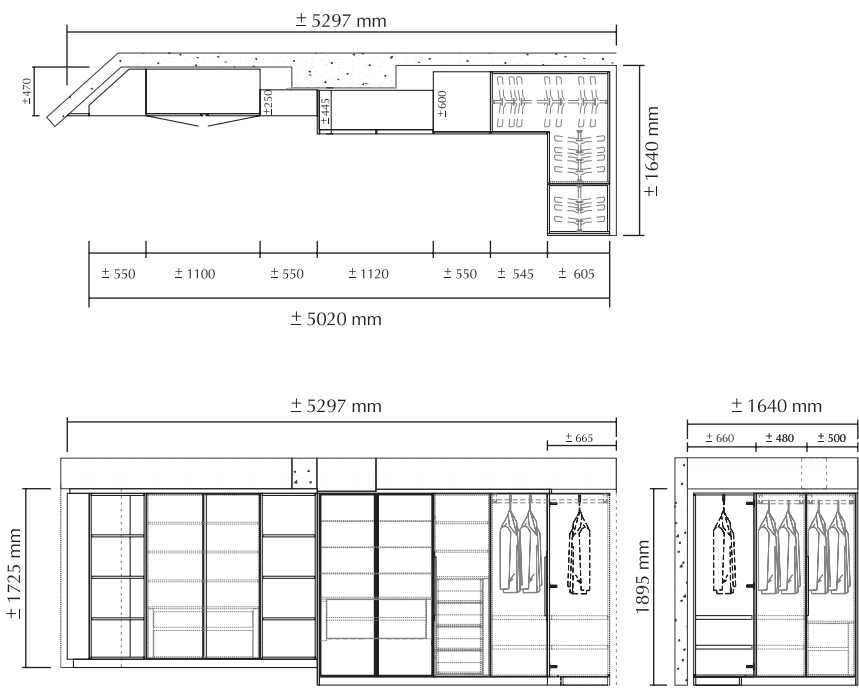



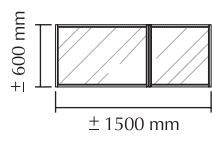
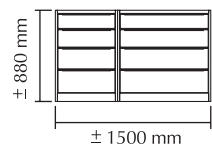

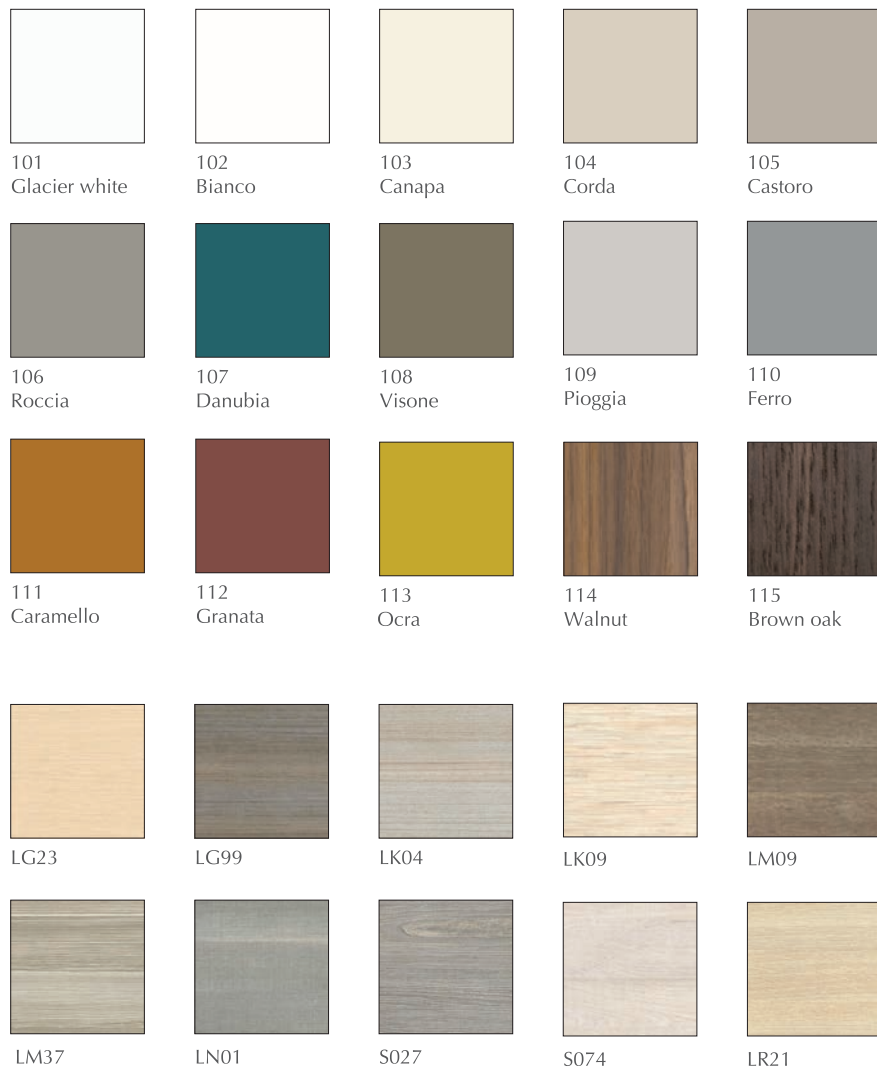

* All colours shown are for reference only
* 顏色只供參考

Wall Unit

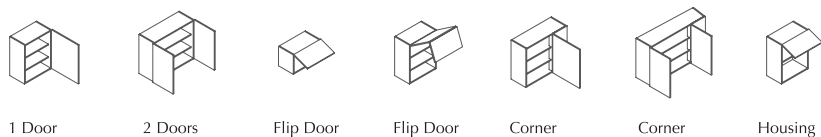

Base Unit

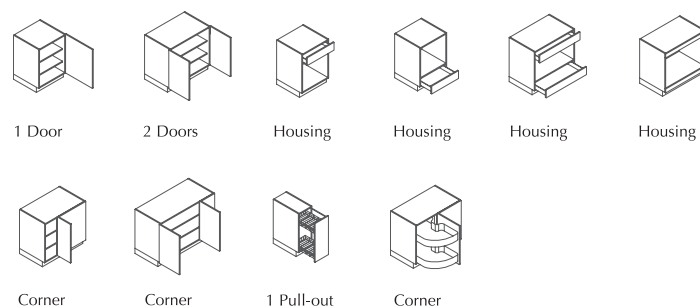

Base Unit (Pull-out)

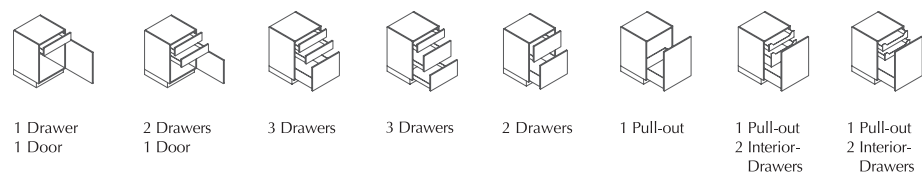

Sink Unit

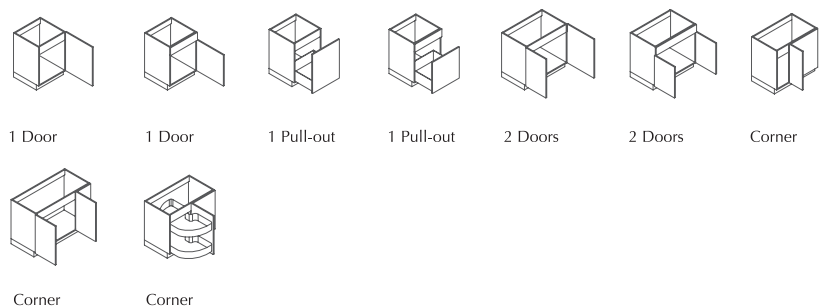

Tall Unit

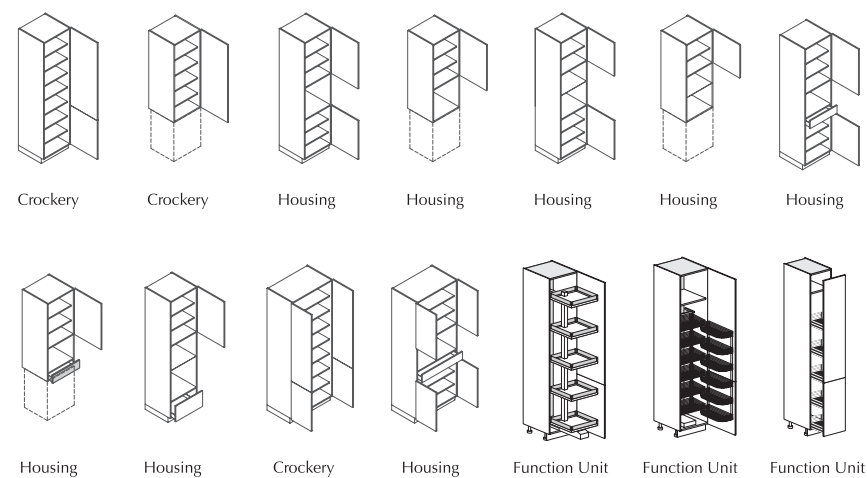

Hob Unit

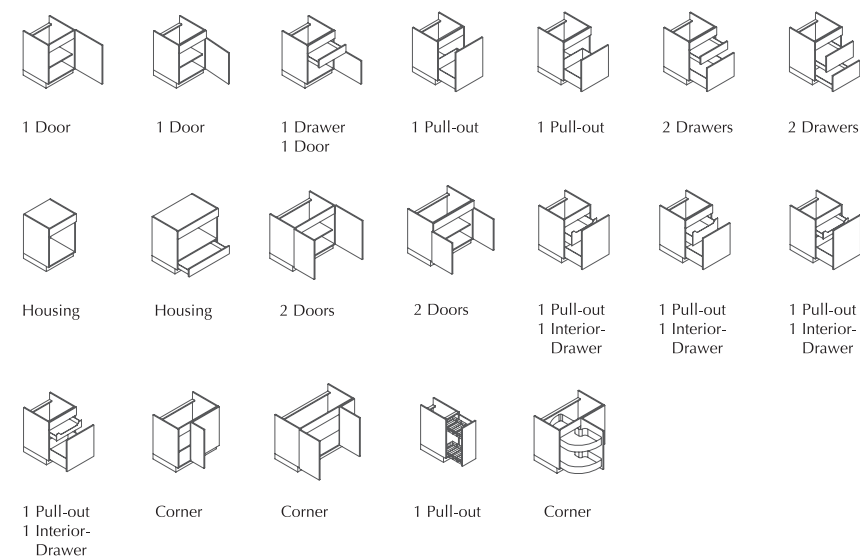

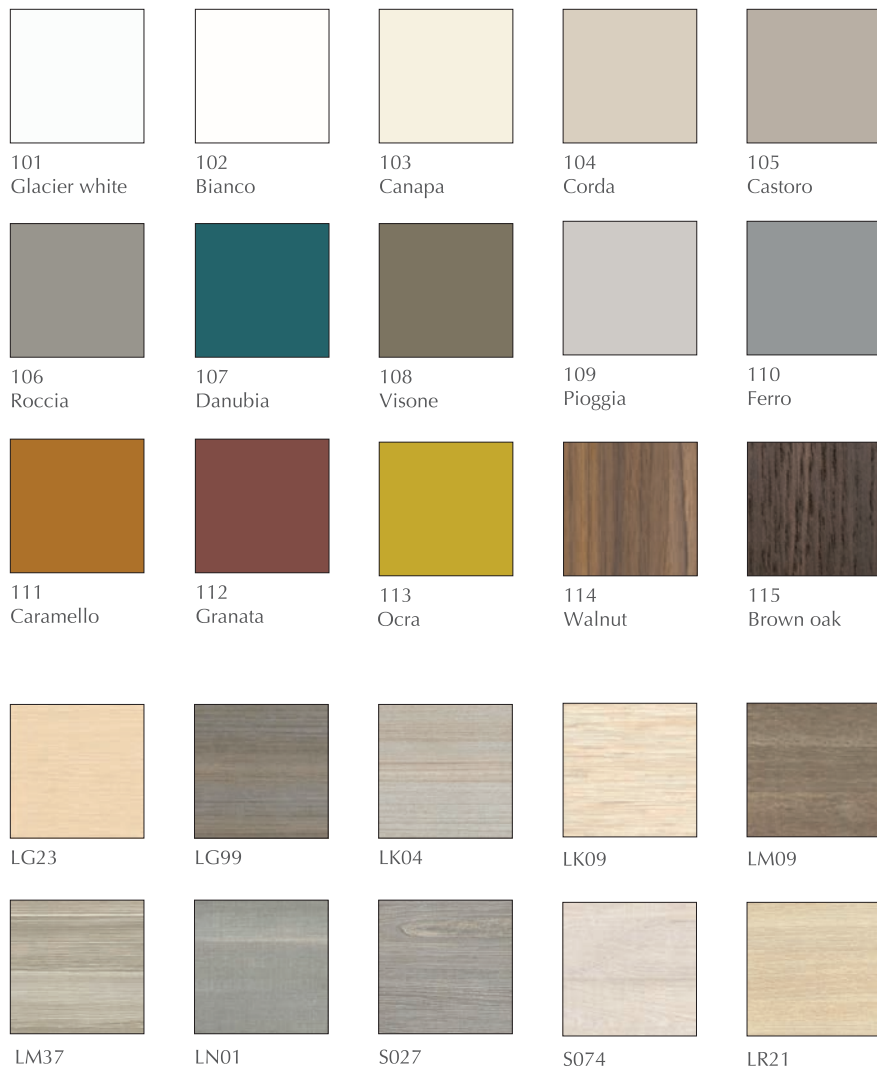

* All colours shown are for reference only
* 顏色只供參考

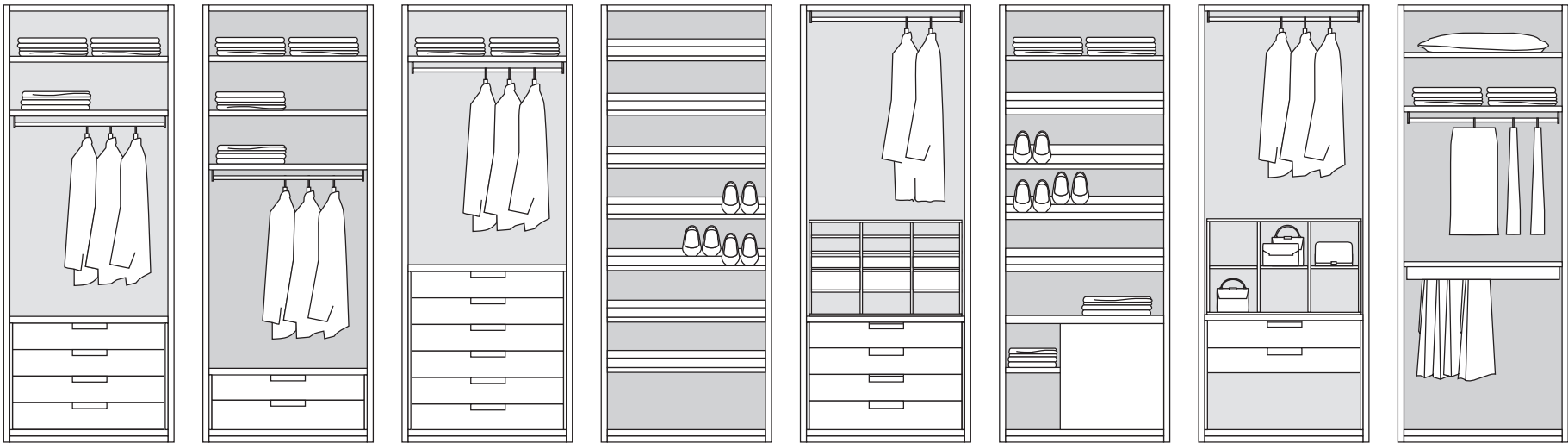

Vespa SHOWROOM 陳列室



G/F 62 Leighton Road, Causeway Bay HK
香港銅鑼灣禮頓道62號

T / (852) 3188 0659
E / info@vespacucine.com



Shop 1 G/F Empire Court 2-4 Hysan Avenue
Causeway Bay HK
香港銅鑼灣希慎道2-4號蟾宮大廈一號鋪

T / (852) 3188 2857
E / info@vespacucine.com



www.vespacucine.com

